

SAW HANDPIECES

OPERATION MANUAL

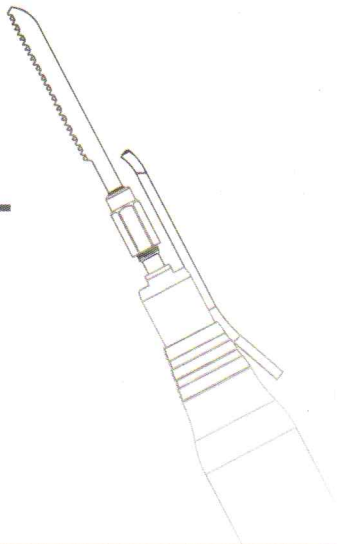

Before using the products, please read the users Manual carefully and follow the operation procedures strictly.



135°C



Achieve for outstanding chip power

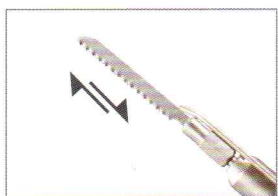

Reciprocating
Up and down reciprocation

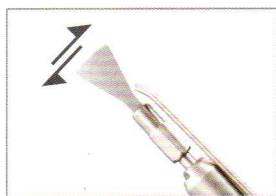

Sagittal
Back and forth reciprocating

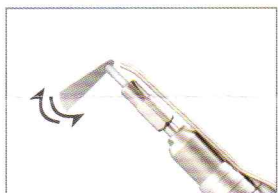

Oscillating
Left and right reciprocation

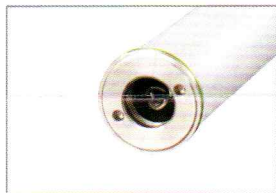

E-type connect

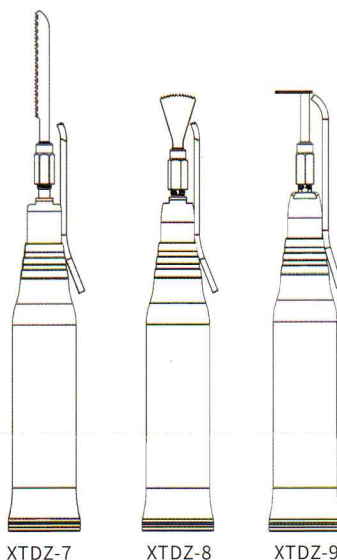

XTDZ-7

XTDZ-8

XTDZ-9

· Saw handpieces for cutting and separating bone substances mechanically in cranio-maxillo-facial surgery .

- For sagittal, oscillating or reciprocal movement
- Low vibration and exceptionally quiet
- Can be dismantled for thorough cleaning

- Clean, disinfect and lubricate the medical device.
- Sterilize the medical device, the saw blades, the coolant tube, the spanner and the nozzle cleaner.

Technical:

Type:	XTDZ-7	XTDZ-8	XTDZ-9
Transmission ratio:	3.2 : 1	4 : 1	4 : 1
Strokes or angles:	1.8 mm	3°	17°
Frequency (strokes/min):	12,300	12,300	12,300
Maximum drive speed:	40,000 min ⁻¹	40,000 min ⁻¹	40,000 min ⁻¹
Working direction:	Sagittal with reciprocating motion, forward / reverse cutting direction	Oscillating with sagittal motion, cutting direction parallel to the axis	reciprocating movement with oscillating motion, cutting direction 90° to the axis



Autoclavable at 135°C max

Up and down reciprocating saw blade

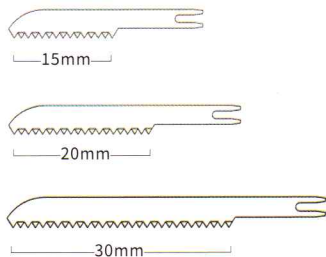
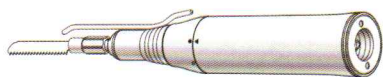

Back and forth reciprocating saw blade

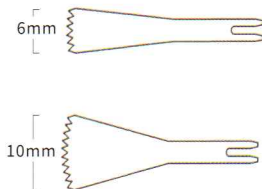
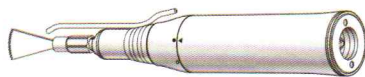

Left and right reciprocating saw blade

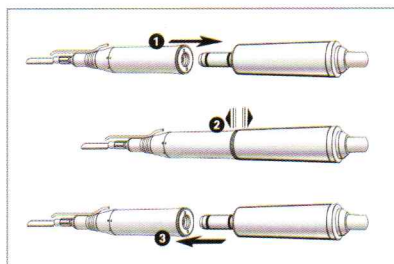
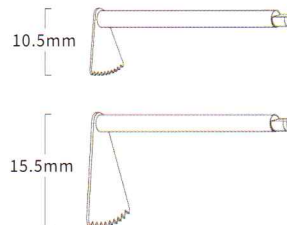
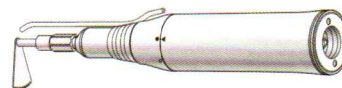

Remove and assembly

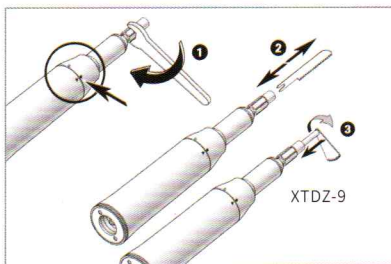

Replace the saw blade

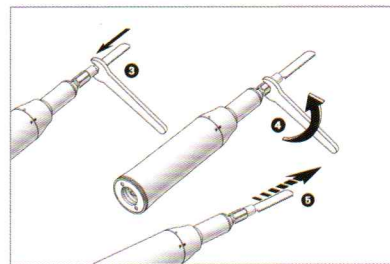

- Do not assemble or remove the medical device during operation .
- Connect the handpiece to the motor.
- Make sure the handpiece is fully engaged with the motor.
- Remove motor device.

- Undo the clamping screw with the spanner or by hand .Ensure that the sheath remains closed.
- Insert the saw blade up to the limit stop or remove it.
- Guide the spanner to the clamping screw and use the spanner to tighten the clamping screw.
- Verify full engagement.

⚠ Hygiene and maintenance

- > Clean the medical device immediately after every treatment, to flush out any liquid (e.g., blood, saliva etc.) and to prevent settling on the internal parts.
- > Clean the medical device under running tap water (< 35°C / < 95°F).
- > Rinse and brush off all internal and external surfaces.
- > Move moving parts back and forth several times.
- > Remove liquid residues using compressed air.
- > Ensure that the medical device is completely dry internally and externally after cleaning and disinfection.
- > Check the medical device after cleaning and disinfection for damage, visible residual soiling and surface changes.
- > Reprocess any medical devices that are still soiled.
- > Sterilize the reassembled medical device following cleaning, disinfection and lubrication.

⚠ Safety notes

- Perform a text run each time before using.
- Check the medical device for damage or loose parts each time before using.
- Do not operate the medical device if it is damaged.
- Only attach the medical device onto the micromotor when the micromotor is at a complete standstill.
- Avoid overheating at the treatment site.
- Do not exceed the maximum allowable driving torque.
- The saw blade should only be removed when the medical device is at rest.
- Only use saw blade that are in perfect condition and be careful when the saw blade is moving.