

# DETACHABLE ULTRASONIC CLEANER

---

## 1200 Instruction Manual >>



The pictures referred to in this manual are for reference only,  
please refer to the actual product.

PLEASE READ THIS INTRODUCTION BEFORE USING  
KEEP THIS MANUAL FOR REFERENCE

Detachable ultrasonic cleaner

- Thank you for purchasing this product.
- Please read the instruction carefully for proper and safe use.
- Please keep the manual for reference.

Index

• Product profile	1
• Security precautions and daily maintenance	1
• Product specification & Detachable function	2
• Product components and function instructions	3
• Button function	3
• Application & Ultrasonic principle & Dirt elimination process	4
• Five ways of cleaning	5
• Operate procedures	6
• Attentions before cleaning & Optional attachment usage	7

Product profile

Compared with the traditional ultrasonic cleaning machine, the detachable ultrasonic cleaning machine increases the detachable function and is more convenient to use. This product is compact and light in appearance, simple and generous, easy to operate, convenient for users to add and pour cleaning fluid, longer service life than traditional keys, better waterproof function.

Security precautions and daily maintenance



To avoid fire, electric shock or personal injury, please be sure to comply with the following requirements, others please follow the state and local relevant electrical codes.

- 1 Working environment: environmental temperature require 0-50°C
- 2 Cleaning liquid: corrosive liquids are forbidden for SUS and ABS, temperature of cleaning liquid should not exceed 60°C.
- 3 Working time: continuous working time should not exceed two hours.
- 4 Storage requirements: please wipe the machine and make sure the place is not wet if do not use it for a long time. (Remember that storage condition is no liquid inside the tank)

- Do not disassemble the product without professionals.
- Unplug the machine before adding water. Do not add more than " MAX- " line to avoid water overflow.
- Do not touch the socket with the wet hand to avoid the risk of electrocution.
- Use the product correctly according to the manual.
- Do not add abrasives or corrosive chemicals to the cleaning tank.
- The machine is not waterproof, do not immerse the machine into the water to avoid the risk of electrocution.

- Do not use the machine unattended.
- Do not use the damaged power cord or plug. If the product does not work properly, please contact us for after -sales service.
- Unplug the machine after using.
- Keep the machine away from heat, and put it at a dry and flat place.
- Please put the machine in a safe place to avoid falling into water or other liquids.
- Although this product is simple to operate, children must not be cleaned and maintained without supervision. Children are not allowed to play with this product.

Product specification

Items	Parameters
Model	1200
Capacity	1.2L(2pint)
Input Voltage	<input type="checkbox"/> AC110V-120V 60Hz <input type="checkbox"/> AC220-240V 50Hz
Ultrasonic power	70W
Ultrasonic frequency	40KHz
Tank size	170*130*65mm
Unit size	228*218*157mm
N.W./G.W.	2.3KG / 2.7KG

(Weight and volume are for reference, please refer to the actual product.)



Cleaning effect will be much better if using the machine together with proper solvent.

Detachable function



- 1 The tank of the same brand model can share a base, and the tank of different brands cannot share a base to prevent damage to the machine.
- 2 When pouring the cleaning liquid, directly end the tank, easy and convenient.

## Product components and function instructions

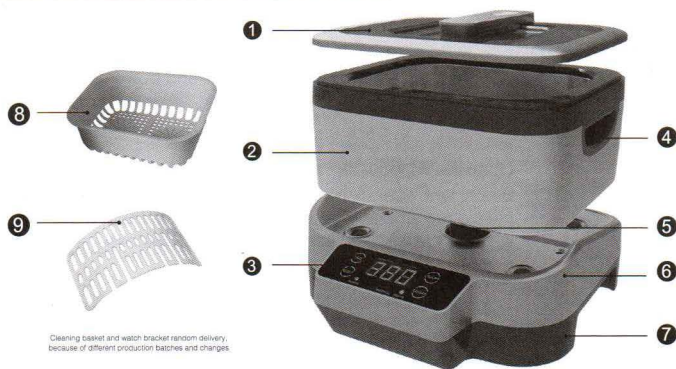

## Button function

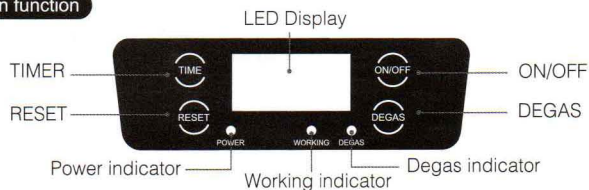

**Timer set (TIME):** Timer recycles by 90s, 180s, 280s, 380s, 480s, invalid when ultrasonic is working.

**RESET:** Press it one time to pause ultrasonic, press it again to reset timer to 180s.

**ON/OFF:** Press the button to stop working. Unplug the machine and pour out the liquid. Then wipe out the tank with dry towel.

**DEGAS:** Press the button to start degas function. The machine will work 9 seconds and stop for 6 seconds. Degassing can separate the oxygen produced during cleaning and improve the cleaning effect.

3 >>

## Application

Glasses and Watch	Jewelry	Daily used
Glasses, sunglasses, chains of watches, etc.	Necklaces, Rings, Earrings, Bracelets, etc.	Electric shaver head, razor blades, dentures, combs, toothbrushes, etc.
Recommended cleaning timer: 1-3mins	Recommended cleaning timer: 1-3mins	Recommended cleaning timer: 1-3mins
Small metal parts	Metal Dishware	Fruits
Watch parts, Ancient coins, Badges, Machine nozzles, etc.	Forks, Knives, Spoons, etc.	Small Fruits and vegetables
Recommended cleaning timer: 3-5mins	Recommended cleaning timer: 3-5mins	Recommended cleaning timer: 3-5mins

## Ultrasonic principle

Ultrasonic is the frequency higher than the scope of human ear can hear, beyond the audible range of the acoustic pulse, the waveform travel through liquid to make cavitate and produce vacuum bubbles. High pressure is generated between inside and outside the bubbles, bigger vacuum bubble, higher pressure, stronger impact force when rupture and higher destructive effect. Different frequency is recommend based on different cleaning articles, no damage to objects and excellent cleaning effect. Ultrasonic also can accelerate the chemical reaction rate and improve cleaning effect if add chemicals.

## Dirt elimination process

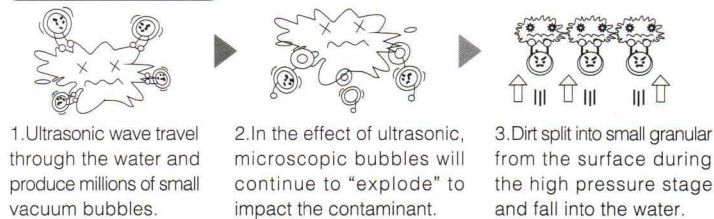

(This figure only shows the principle of ultrasonic cleaning, and the actual tiny bubbles are invisible to the naked eye.)

4 >>



## Five ways of cleaning



### General cleaning

Just use tap water, items or parts to be cleaned should be completely submerged in the water. Do not add more than "MAX-" line.

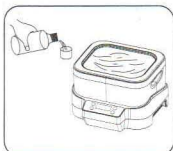

### Add detergent cleaning

When the articles are not cleaned for a long time or the dirt is stubborn, add the appropriate amount of household detergent in the water according to the different types of articles, so as to accelerate the decomposition of dirt and improve the cleaning effect.

Note: After using the Add detergent cleaning, the cleaning effect can be improved by repeating the cleaning or lengthening the cleaning time.



### Segment cleaning

Longer items can be cleaned in sections as shown.



### Re-cleaning

When the article in the use of "add detergent cleaning", the cleaning effect is still not ideal, you can change the water repeat this step for repeated cleaning, until the ideal cleaning effect.



### Cross-infection avoidable cleaning

Put same kind of articles in water cup to avoid cross-infection.

Note: during the cleaning, the amount of detergent and cleaning time depending on the different parts and how dirty they are.

## Operate procedures

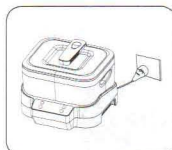

### Check machine

Plug in, check the display and make sure the machine in powered, LED display shows "180" and power indicator is on



### Open the lid, pour tap water into SUS tank

Empty tank operation is forbidden, it would damage machine, please put articles into water. (The article should submerge well into the water, water level should not exceed "Max" mark.)

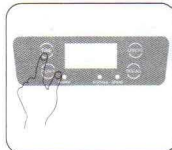

### Timer setting and pause reset

Touch "TIME" button to set cleaning time as needs (90s, 180s, 280s, 380s, 480s, 5 working cycles adjustable). Click "RESET" button to pause cleaning at any working time or restore time to "180s".

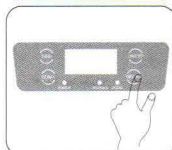

### Degas Function

Press the "degas" button to start degas function, the ultrasonic will work for 9s and stops for 6s until the the setting time is over. Degassing can separate the oxygen produced during cleaning and improve the cleaning effect.

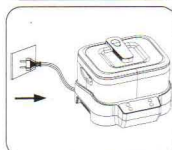

### End of Work

When the cleaning is finished, pour water from SUS tank and wipe it out. Please ensure that no liquid inside if store the machine for a long time.

### ▲ Warning

1. Do not put the mobile phone or watch dial plate into the tank for cleaning.
2. Do not wash the frames or artware made of shell or tortoiseshell by this machine.
3. Any loose inserts may come off during the cleaning process.  
Do not clean the product which didn't insert well.
4. Do not wash clothes, leather, wood and other easily fading products by this machine.

### Attentions before cleaning



Watches are precision instruments, it is not recommended to put the whole watch into the water, even if waterproof. You'd better wash it with hand holding or watch bracket. Add a few drops of detergent works better.



The glasses should be placed face up. Only need 1-3mins for cleaning. Add detergent evenly on glasses can work better. For glasses with lens film or frame coating process, please consult the optician to confirm whether it can be used with ultrasonic cleaning to avoid unnecessary losses.



If the jewelry is oxidized, you can kindly use silver washing liquid before ultrasonic cleaning. Add a few drops of detergent works better. (Please confirm the inlay of diamond rings, necklaces are intact and firm, or maybe fall off by the ultrasonic.)

### Optional attachment usage



#### Basket

When cleaning small items, items can be placed in the basket, and then put the basket into the tank, which can reduce the friction between the goods and the wall of the inner tank.

#### Attention:

The basket is specially designed for small items, because the basket will absorb 30% of the ultrasonic wave, so it will affect the cleaning effect. In this case, if you use a basket to clean the contents, follow the instructions "add cleaning solution to clean".



#### Watch bracket

Secure the watch with the watch bracket, then immerse the chain part into the water. Similarly, the bracket will also absorb ultrasonic waves, so in the use of watch bracket cleaning watch, please add a few drops of detergent for work better.

#### Attention:

Watches belong to precision machinery, do not put the whole watch into the water, just clean the chain parts.

Different models, different batches, the optional attachment will be different, please take the received in kind as the standard

## Certificate of conformity

Product name : Ultrasonic Cleaner

Model : 1200

Inspectors : 

Test result : 

## WARRANTY CARD

Cause of issue	Maintenance records	Maintenance time

### Warranty notes

Thank you very much for purchasing this product! The relevant certifications of our products are complete, and all products have been strictly tested before delivery. From the date of purchase, we promise to provide "one-year warranty, lifetime maintenance" service, but the return freight is borne by the buyer, and the maintenance service outside the warranty scope will be charged according to the actual situation.

The following situations are not covered by the one-year free warranty: 1. Exceeding the warranty time; 2. All man-made damage; 3. Failure to operate, maintain, and keep in accordance with the product instruction manual causes damage; 4. The user disassembles the machine for maintenance without permission; 5. Without this warranty card or altering the warranty card without authorization; 6. The product model on the warranty card does not match the actual product; 7. Damage caused by force majeure during use, such as floods, earthquakes, etc.

### Return & exchange Precautions

Please complete the return and exchange content, reason, model, purchase time, contact person, phone number, Consignee address, and strengthen the packaging before sending back. Please ensure that the packaging of the tank of the returned machine is complete and clean. If the tank or the appearance is dirty, scratched, deformed and other factors that affect the secondary sales, the return will not be refunded; if the product is damaged due to packaging problems, the warehouse will directly refuse the parcel. Also refuse to receive the parcel with freight collect, thank you for your cooperation!