

**OPERATING AND
MAINTENANCE INSTRUCTIONS****BEST
THERMOSEALER****FOREWORD**

The present operating instructions are intergral to the unit.They are to be kept within reach and constantly used by people profiting and operating the unit itself.The operating instructions are always to come with the untt,when the unit is sold to a different user too.

Any operator is liable to read the operating instructions and strictly comply with its instructions and informationg as **best** is not liable at all for any damage to peop;e or thing or to the unit,should the operator not comply with the hereby described general operating conditions,

Such instructions are confidential and the customer is liable not to disclose any information to third parties, What is more such operating instructions and its annexes can not be changed,tampered,modified,violated,copied or sold to anybody without **best** approval.

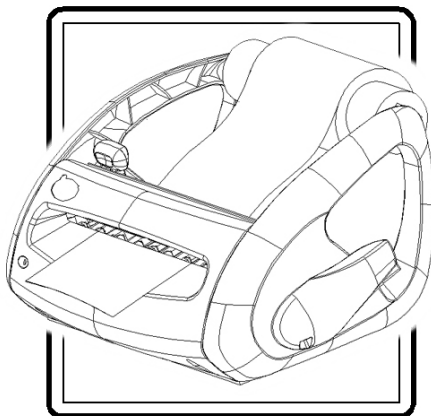



INDEX

INTRODUCTION	1
FOREWORD	1
INDEX	2
<i>References numerical index</i>	3
<i>Graphical reference representation</i>	4
GENERAL SUPPLY CONDITIONS	5
DOCUMENT SCOPE	5
<i>Annexe list</i>	5
PERSONNEL DEMANDED QUALIFICATIONS	6
OPERATING USE	6
TECHNICAL SPECIFICATIONS	7
<i>Technical specifications tablex</i>	7
<i>Identification and marking</i>	7
<i>Reference standards</i>	7
ACCIDENT PREVENTION	8
IGENERAL SAFETY CONDITIONS	8
<i>Thermal danger</i>	8
<i>Environmental conditions and risks</i>	9
<i>Residual risk table</i>	9
TRANSPORTATION and PACKAGING	10
GENERAL CONDITIONS	10
<i>Unpacking and unit cleaning</i>	10
<i>Storage</i>	10
INSTALLATION	11
GENERAL CONDITIONS	11
<i>Setting</i>	11
<i>Electrical connections</i>	11
INSTRUMENTS	12
INSTRUMENTS	12
<i>Led</i>	12
<i>Lever</i>	12
<i>Cutting tool</i>	12
<i>ON/OFF switch</i>	12
OPERATION	13
GENERAL CONDITIONS	13
START UP	13
SERVICE	15
GENERAL CONDITIONS	15
<i>Cleaning</i>	15
DISPOSAL AND SCRAPPING	16
ELECTRICAL LAY OUT	17
ELECTRICAL LAY OUT	17



References numerical index

01	blade.....	9, 15
02	power cable.....	5, 11, 15
03	roll holder.....	5, 13
04	packet tray.....	5, 7, 11, 14
05	ON/OFF switch.....	12, 13, 17
06	LED.....	12, 13, 14
07	rear slot.....	13
08	front slot.....	8, 9, 14
09	lever.....	9, 12, 13, 14, 17
10	cutting tool.....	8, 9, 12, 13
11	feet.....	11

Graphical reference representation

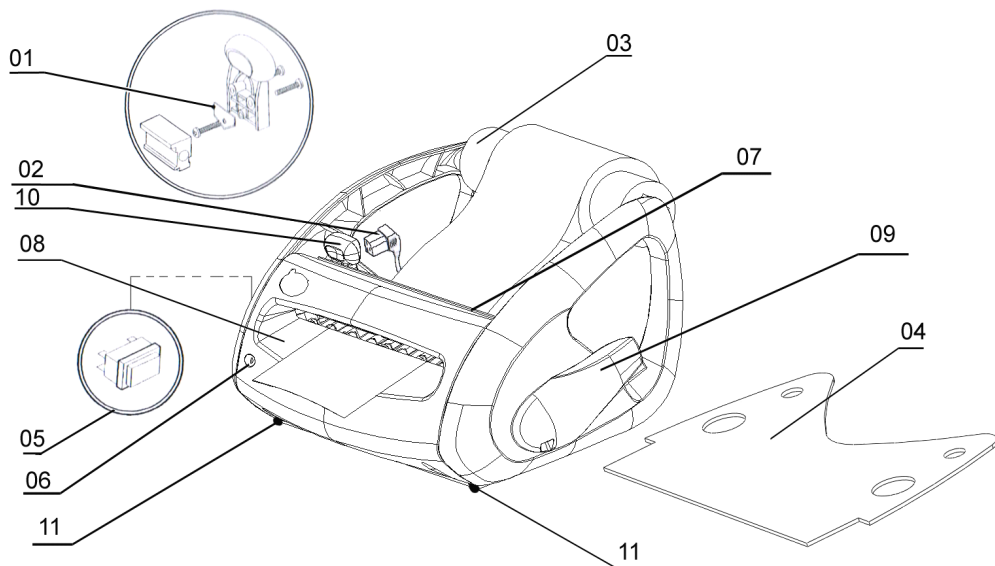



GENERAL SUPPLY CONDITIONS

BEST hereby declares that the unit complies with any regulation in force within the European Union and provides for the hereby enclosed CONFORMITY DECLARATION.

BEST accepts and undertakes to check and possible manufacturing defects appearing within 24 months from the unit installation (refer back to the guarantee). The customer is liable for using original spare parts and for fitting them according to their forecast use and operation.

Reference manufacturers are liable for any fitted accessory.

BEST is not liable for defects or wrong operation depending on the unit incorrect use, changes after transportation or specific environmental conditions; missing or incorrect maintenance, tapering or incorrect repairing.

BEST is not liable in the case the installation is not compliant with the hereby enclosed instructions or if not be carried out by duly trained and qualified personnel. **BEST** accepts NO responsibility for the disposal of materials relating to the transport, machine use or production. Customers must thus see to the disposal of such potentially harmful substances themselves, always observing the laws operating in the country of installation.

The same apply to the unit dismantling.

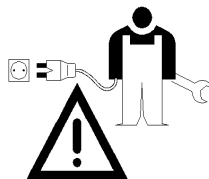

DOCUMENT SCOPE

The operating instructions (OPERATING AND MAINTENANCE INSTRUCTIONS) are only to be considered a reference to safely operate the unit or to carry out any maintenance as to keep the unit under consistent general conditions.

Instructions and information within the operating instructions do not replace at all any safety standard and technical data relating to installation or operation, directly fitted to the unit as well as any common sense rules or safety standard in force within each single country.



Any professional working on the unit is liable for reading the operating and maintenance instructions; they are to be informed on residual risks depending on the unit operation or sterilized products.



Annexe list

Besides the operating and maintenance instructions, the unit comes with:

N°

(STANDARD Supply ●)

Warranty certificate	1	●
EC compliance declaration	1	●
Power cable 02	1	●
Roll holder 03	1	●
Packet tray 04	1	Optional



PERSONNEL DEMANDED QUALIFICATIONS

Operators in charge of the unit operation and maintenance are to be trained, aware and informed of any activity and skilled enough to correctly interpret what specified in the present operating instructions and to provide for safe and accurate controls.

Even though it is not possible to provide for any information required and targeted to the different unit operations, any operator must at least be qualified and trained for the activity and the role he plays.



Operators directly working on the unit are to wear any required personal protection means: gloves to be protected against cutting or pointed objects or from heat.



It is absolutely forbidden to employ unskilled, non qualified, alcohol-addict or drug-addict operators.



It is not possible to check training and/or train operators working on each single unit, according to the operator role within the company, each single operator is to be qualified enough and he is liable for any risk depending on his specific activity and job.

OPERATING USE

It is absolutely forbidden to use the unit or its parts for different reasons and operations from what hereby detailed described.

It is absolutely forbidden to incorrectly operate the unit or to operate the unit differently from what specified in the operating use chapter.



The machine has been designed to:

SEAL AND CUT PAPER/POLYPROPYLENE PACKETS AND ROLLS CONTAINING AUTOCLAVABLE SURGICAL DIAGNOSTIC OR MEDICAL INSTRUMENTS , FOR EXAMPLE : SCISSORS , SCALPELS , GAUZE , ETC.

The unit can NOT be operated or installed in specific areas at the presence of gas or any other explosive volatile substance.



**Technical specifications table**

		U.M.	
<i>Packet tray 04</i>			Optional
Electrical supply voltage and frequency	V-Hz		Volt 230 – Hz 50/60
Power	W		100
Length of seal	mm		250
Width of seal	mm		10
heating			Monolateral
Start-up			Manual
Weight	kg		7
Dimensions:			
width	mm		445
height	mm		205
Depth	mm		325
Packaging dimensions:			
Width	mm		515
Height	mm		330
depth	mm		390

Reference standards

The unit was designed in compliance with the following standards:

73/23/CE	Low voltage directive
93/68/CE	
89/336/CE	Electromagnetic compatibility directive
92/31/CE	
93/68/CE	

Identification and marking

Nameplates on the unit ARE NOT to be removed,damaged,dirtied,hidden,etc...
Nameplates are to be periodically cleaned,kept visible at sight,NEVER hidden
With foreign objects or pieces.



Technical data in the operating instructions do not replace data on the nameplates fitted onto the unit . The data nameplate is fitted to the unit back .



GENERAL SAFETY CONDITIONS

Any operation, different from the operating cycle, is to be carried out when the unit is cut from the main power supply. The main power supply is to be fitted with the required grounding..

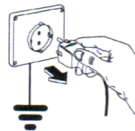

What is more operators are to be correctly informed.

It is compulsory for them to read the comply with any technical information in the present operating and maintenance instructions and in the enclosed documents.



Avoid any unsafe repairing. Any repairing is to be carried out with original spareparts only, to be fitted according to their specific use.

Never remove any part from the unit.

Only authorised and previously trained person by Best can remove the exterior protection cover and access the interior parts.

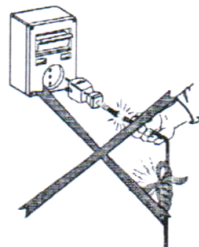

Nameplates on the unit are not be removed, damaged or dirtied. They are to be kept clean and perfectly readable.

Refrain from using the unit in case of troublesome or abnormal operation.



Information in the present operating instructions do not replace any safety instructions or technical data to be followed during installation and operation on the unit itself. Nor any safety standards in force in the installation country as well as any other common sense rule.

The unit is to be cleaned using suitable means and detergents which are not affecting the unit parts. It is absolutely forbidden to clean or wash the unit with water jets. Never lean liquid containers onto the unit upper portion or in the above shelves. A possible leakage or spillage inside the electric installation can lead to a short circuit.

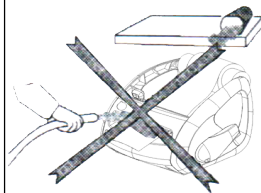

Thermal danger

The sealing bar can reach high temperature

Do not put fingers into the front slot 08 or the space where the cutting tool 10 runs.



Environmental conditions and risks

The unit can not be installed outside or under unfavourable weather conditions(sun, rain,snow,wind).

What is more check that there is no electro-magnetic interference which could affect data on any electronic equipment.



The unit is not serially fitted to be operated where fire or explosion risks high.



BEST accepts No responsibility for the disposal of materials relating to machine use or production. Customers must thus see to the disposal of such potentially environmentally harmful substances themselves. the same precautions are to be adopted when demolishing the machine.

The unit was designed in compliance with good practice and standards relating to energy saving, avoiding wastes and useless dispersions.

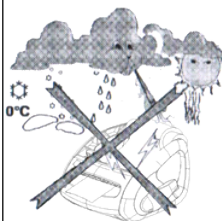

Residual risk table

RISK ANALYSIS AND DESCRIPTION	SUGGESTED REMEDY
Heating element at temperature, sealing bar and cutting tool 10 closed	Do not put fingers into the front slot 08 or the space where the cutting tool 10 runs.
Poor cleaning or scratches on lables and/or instruments can cause errors with resulting dangers.	Clean instruments and lables thoroughly with suitable products.
Substitution of cutting tool blad 01 can be a source of danger	Take proper precautions to avoid getting cut and do not throw the blade away with wrapping it properly
If lever 09 is operated brusquely and held wrongly, the fingers can be caught.	Operate lever 09 with care



GENERAL CONDITIONS

The unit is generally protected by a packaging, consisting of a cardboard box. Lifting and transportation are to be carried out by qualified person only. Weight and size are specified in the chapter TECHNICAL SPECIFICATIONS. The unit transportation, mainly on road, is to be carried out profiting from suitable transportation means and paying due attention to protect the different parts (mainly electronic) from bumps, creashes, moist, vibrations and son on.

Unpacking and unit cleaning

Remember that packaging (wood, nails, paper, plastic, metal staples, adhesive tape, straps, ropes) can cut and/or injure, if not carefully handled.



They are to be removed special means and not left within reach (especially children). the same applies to any device used to remove package (scissors, hammers, tongs, knives, etc...).

Any packaging part is to be removed and disposed according to the regulations in force in each single country.

It is advisable to keep the packaging should it be necessary to move the machine. First of all, once opened the packaging, thoroughly check pieces and parts the unit consists of. Check that any demanded part is present as well as its general conditions (refer back to SUPPLY CONDITIONS).

In case of defects or deteriorations, immediately interrupt any operation and immediately get in touch with shipping or forwarding agent and promptly inform BEST.



Storage

Should the unit not immediately used or removed from the installation site, it is to be stored in a dry place and duly protected.

When the unit is to be covered with plastic layers, fit in silica gel or any dehydrating system inside the packaging.

Ideal environmental conditions for storage are:

-Temperature -25°C --- +40°C

-maximum relative humidity 90%.

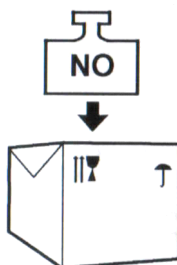

Never lean anything on the unit packaging and more precisely loads with protruding feet or screws.



GENERAL CONDITIONS

The unit installation is to be carried out according to the customer requirements and on the site the unit is to be fitted in. It is therefore important that the customer promptly inform BEST on possible special conditions (environmental conditions, size or built-in limits, etc.).

The operation is to be carried out by trained and qualified personnel only; it is important to comply with what specified in the present operating instructions and with technical diagrams and documents.



In general, it is necessary:

- to check that any environmental condition is correct (explosion risk, excessively aerated areas, high humidity);
- to check that the unit is not exposed to any adverse weather conditions, such as sun, rain, wind, etc...;
- to check that power supply complies with what specified on any nameplate on the unit;
- to check that the power supply is correctly grounded.

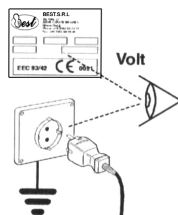

Avoid any electro-magnetic interference which could affect the electronic equipment correct operation, leading to consequent dangers.



Setting

The machine should be installed in: a laboratory; a doctor's/dentist's or similar surgery; where access is allowed only to authorized persons.

IT MUST NOT BE INSTALLED:

- near a heat source
- in area containing volatile or explosive substances;
- below or above other electrical apparatus in operation;
- in unsuitable built-in furniture;
- without the feet 11 provided;
- in domestic environments or others where untrained persons have access;
- on soft or unstable surfaces or on wheels.

Position the machine where it is to be installed; on a firm and perfectly horizontal surface.

When the device is in continuous use or when heavy instruments are to be packaged it is advisable to fit the packet tray 04 (optional).

Where the thermosealer is wall-mounted, holes bored in the wall should use rawl plug and use the holes on the back-plate to fit the machine to the wall.

Electrical connections

When connecting the unit to the power supply, the power cable 02 is fitted into a suitable socket (refer back to the GENERAL CONDITIONS and technical feature table).

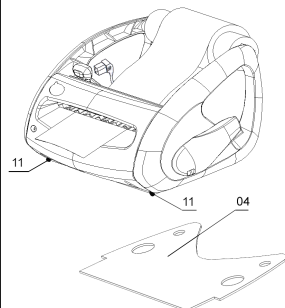

INSTRUMENTS

Led

State of led 06	Indication	Recommended action
Steady green light	Apparatus ready for use	Use apparatus
Green flashing light	Heating underway	Wait till heating ends
Green light flashing with reduced frequency	ECO-mode(energy saving)	Return to normal functioning by operating lever 09 for a moment,otherwise switch apparatus off
Steady red light	Sealing over(where bar has been closed for 3 seconds); sealing bar not sufficiently hot(where bar have only just been closed)	Re-open sealing bar by raising lever 09
Red flashing light	Sealing bar broken	Substitute the sealing bar

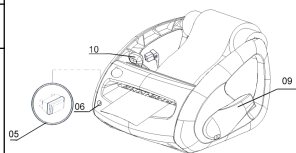

Lever

Lever 09 allows the sealing bar to close.

Cutting tool

The cutting tool 10 allows the packets to be cut once heat-sealed.

ON/OFF switch

The ON/OFF switch 05 allows the apparatus switched ON/OFF

GENERAL CONDITIONS

It would be extremely important to extensively know the available INSTRUCTION;to avoid damages to the unit and to the operator.therefore it is suggested to carefully read instructions in the operating instructions and in case of doubts or non compliance among the different instructions,ask for more detailed information.

Refrain from operating the unit if:

- not qualified enough to operate the unit or similar units;
- it is impossible to understand how the unit works;
- there are possible operation failures;
- there are doubts or contradiction,misunderstanding and misinterpretations between self experience,the operating instructions and/or different operator.



Carry out any operation described before such a chapter and then move to the START-UP.

START-UP

To start the machine:

- Inset one or more rolls, leaving a space between one roll and another on the roll holder 03 and position the latter in its housing.
- Press ON/OFF switch 05.LED 06 turn green and starts flashing: the thermosealer is heating the sealing bar.when this phase,which lasts 3/4 mintes,end the LED stops flashing and thermosealer emits a beep:the apparatus is ready for use.if the operator turn the lever 09 before the heating phase finishes,LED 06 turn red and the buzzer sounds to signal that the sealing bar is not sufficiently hot:re-open the sealing bar by turning the lever in the opposite direction nd wait until the heating phase finishes.
- Unroll and insert the flap on the roll into the rear slot 07,checking that the plastic part is facing up.
- Pull off the flap of the sheet towards the back until you have the length required to wrap the object to be sealed.
- Turn the lever 09 to close the sealing bar and operated the cutting tool 10 manually(the sheet is cut after sealed part).

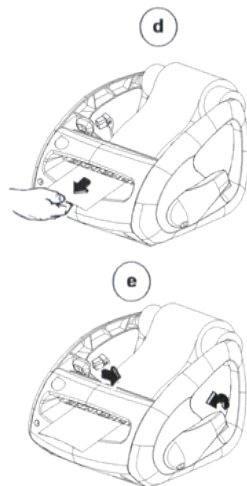

Warning:no object should be between the sealing bars apart from the racket to be sealed as this could damage the heating element.

Do not seal without the sheet.



- When the sealing phase ends LED 06 turns red and the buzzer sounds to signal that the sealing bar should re-opened,by operating lever 09 in the opposite direction.if the operator leaves the lever in the down-position for more than 10 seconds,the heating of heating bar goes off so as not to turn the packet and protect the components of the thermosealer.still after every sealing operation,the apparatus checks that the sealing bar is at the correct temperature and,if necessary,activates the heating for a few moments(see the points B).

- g. Remove the packet created and put in the object to be sealed.
- h. Insert the open end of the packet into the front slot 08 with the plastic part facing up: the packet tray 04 maybe useful in this operation(optional).
- i. Repeat the sealing operation indicated inpoint E and F to close the packet.push back the flap of any roll that might be present.

At the end of the operation press the ON/OFF switch 05.

Once the sealing is finished check the seal,tugging lightly on the flaps of the packet.

If the operator has left the thermosealer on and does not use it for at least 30 mintes, it goes into ECO-mode: the sealing bar switches off to preserve it and not to consume energy uselessly.when it is in this mode green LED 06 flashes with a reduced frequency.to return to normal functioning,operate lever 09 for a moment to activate the heating.

The thermosealer checks that the sealing bar is working properly: if not the powersupply to the bar is cu off and the red LED starts flashing,in addition,the buzzer sounds for 3 seconds.

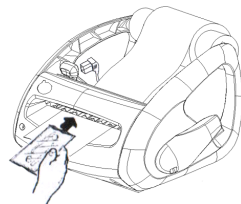
h



GENERAL CONDITIONS

Any maintenance is to be carried out by qualified and technical trained personnel only.



Maintenance is to be carried out when the unit is not working,duly cut from the main power supply,If not differently specified.

Wait for the unit to be perfectly stopped,that there is no longer any surface excessively hot and in any case pay the due attention when operating the unit.



Avoid any unsafe repair,Repairs are to be carried out with original spare parts only.

Always wear individual protection means.



The person responsible for maintenance must immediately report any anomaly scratches,fraying,etc....

Do not allow the unit to be used in case of whatever problem and ask for the correct unit recovery under normal condition and in any case check that the unit conditions were recovered.



BEST will accept no responsibility when maintenance is entrusted to persons that are not competent or when the procedures recommended by our installation engineer are not heeded.

In case of failures which can not be solved simply referring to operating instructions address a BEST AUTHORISED DEALER.



Cleaning

Clean the apparatus weekly using non-corrosive products and with the power cable 02 disconnected.

Before re-using the apparatus,remove any traces of humidity.



Weekly

Substituting the blade

Check and/or substitute the blade 01 annually or as required so as to ensure a perfect cut.



Yearly



DISPOSAL AND SCRAPPING

Should the unit be dismantled,to correctly dispose of its different parts,comply with regulations in force in each single country.however avoid polluting.



ATTENTION: BEST is not liable at all in the case of damages to the systems used for the unit disposal or used for its operation.

Disposal of the different materiala the unit consists of in special authorised landfills.



ELECTRICAL LAY-OUT

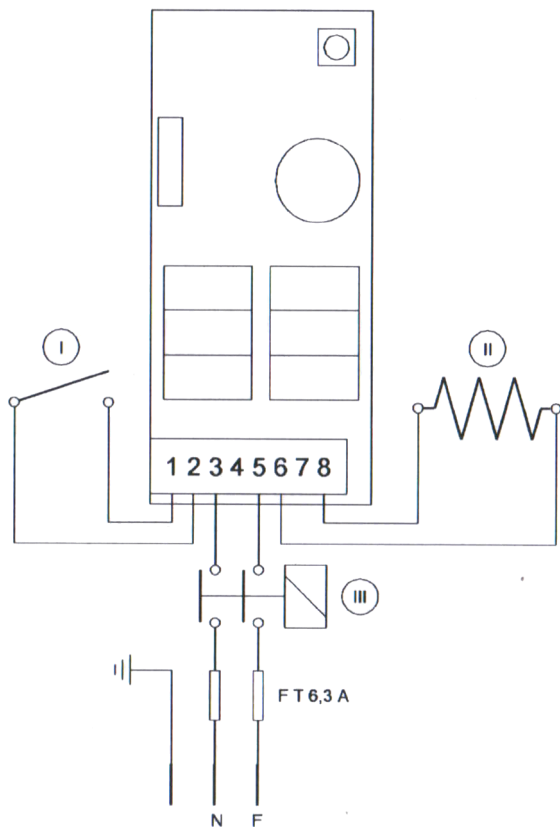

I = Microswitch for lever 09

II = Sealing bar

III= ON/OFF switch 05