

OPERATION MANUAL

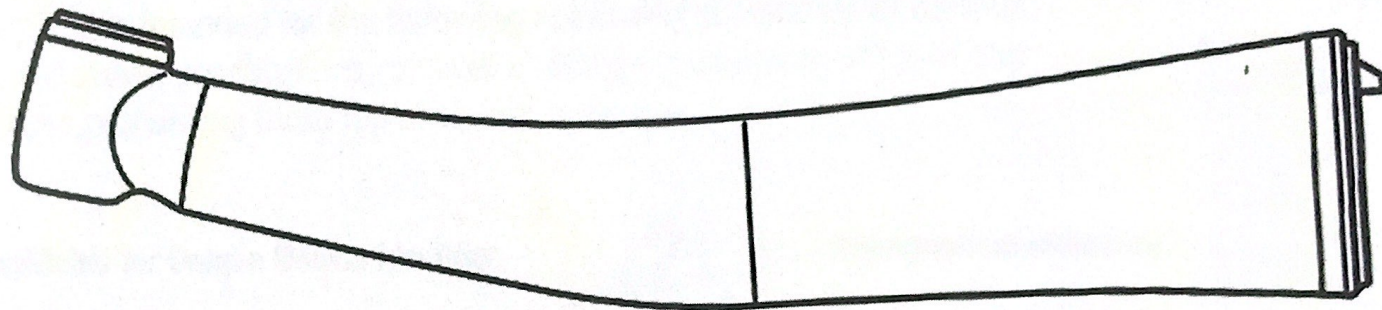

Please read this Operation Manual carefully
before use, and file for future reference

MADE IN CHINA

OM-C0353E 005

Indications for use:

The dental handpiece is intended for the following applications: Removal of carious material, cavity and crown preparations, removal of fillings, processing of tooth and restoration surfaces, processing tooth replacement materials.



GS1 DataMatrix for Unique Device Identifier.



If.....(Hypothetical situation)



Prohibited / Process NOT permitted / Wrong



Call for maintenance



Do the step / Process permitted / Correct



Recommend



Do not use any object with a sharp edge.



Move in the direction indicated.



Clicking sound



Caution, hot surface



Drying time



Medical Device



Drinkable tap water



Move fully to the stop, in the direction indicated.



Specifications



State of being fixed.



The instrument can be used with a washer-disinfector for thermal disinfection.



WARNING

WARNING: Hazard that could result in serious injury or damage to the device if the safety instructions are not correctly followed.

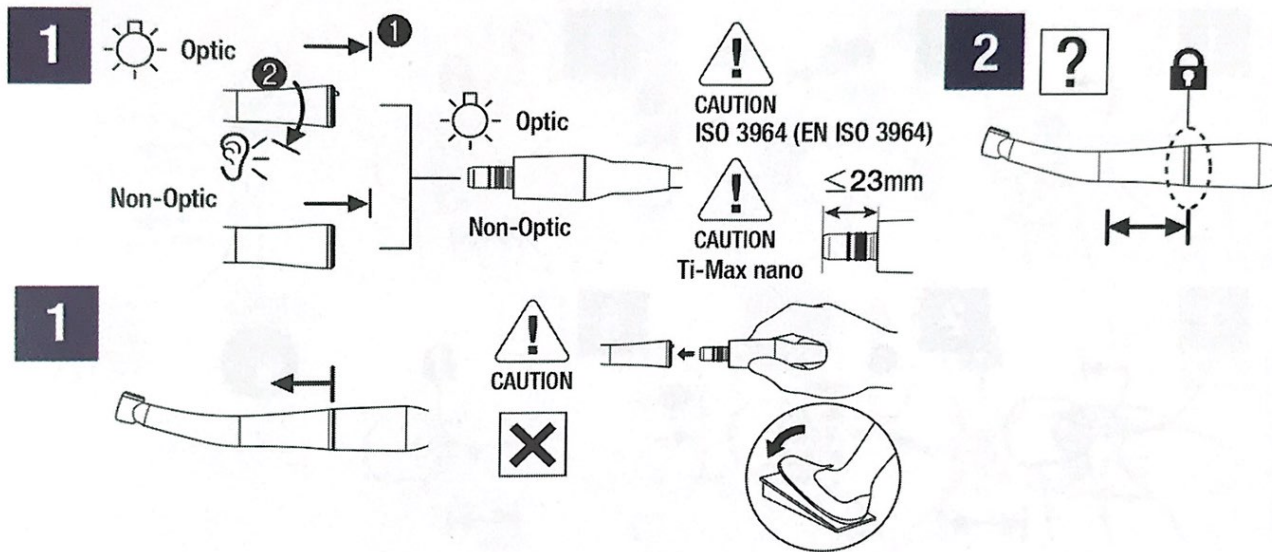
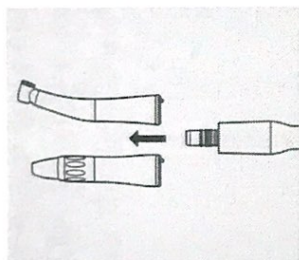
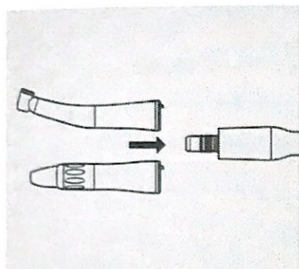

Do not exceed the Max. Rotation Speed (Motor) shown in the specifications in this operation manual.

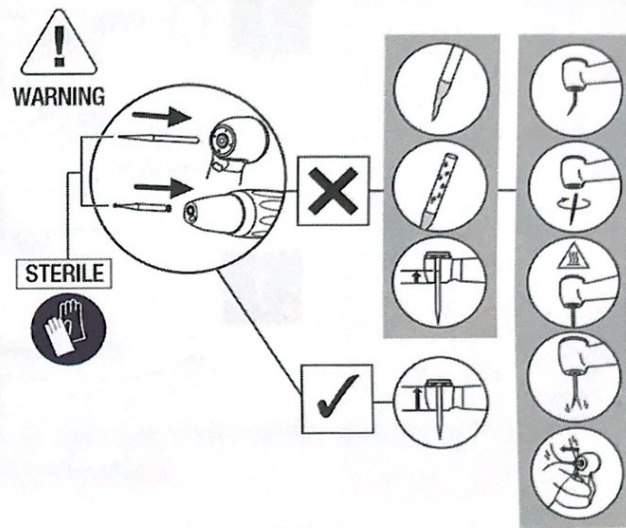
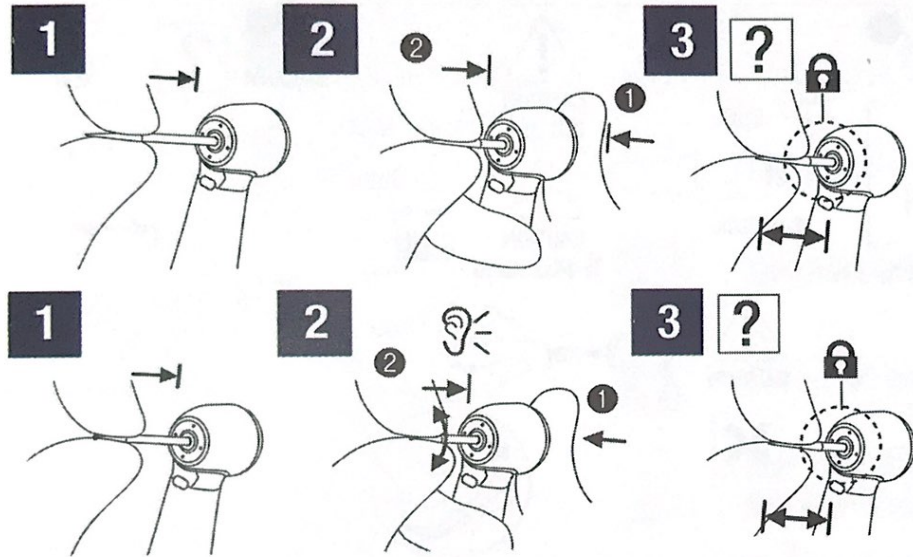
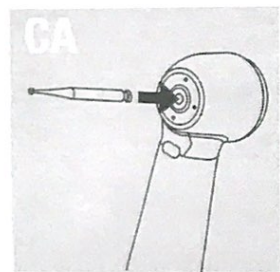
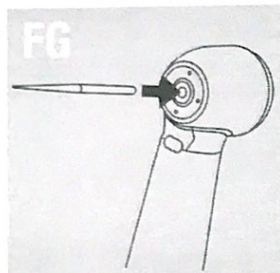

If blood or debris is stuck, wipe in and around the bur insertion hole with a cloth moistened with disinfectant solution until all residues are thoroughly removed. Residual blood or debris may enter the handpiece while changing burs, which could lead to higher risk of cross-contamination.

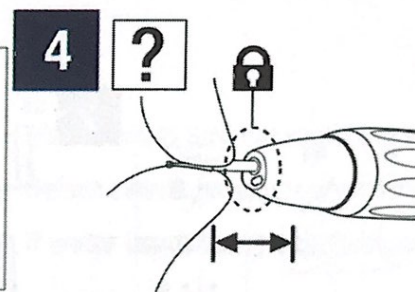
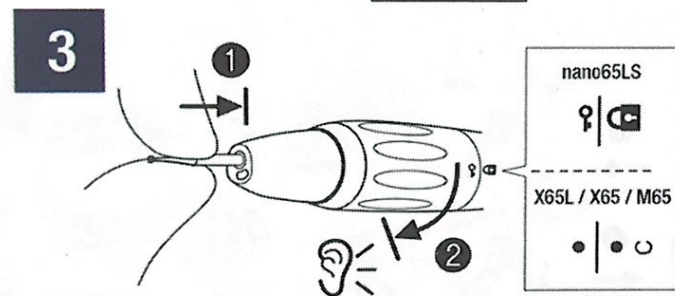
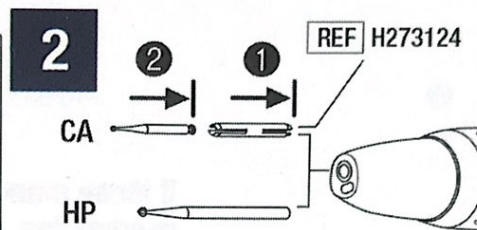
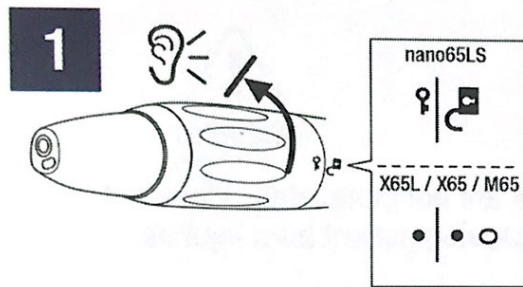
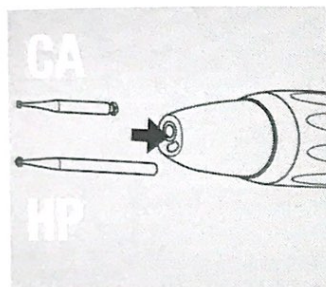

Always follow the instructions provided by the bur manufacturer regarding the bur usage and rotation speed, etc.

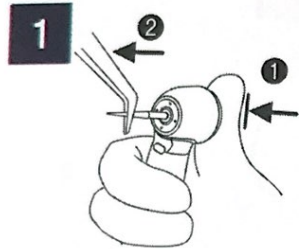
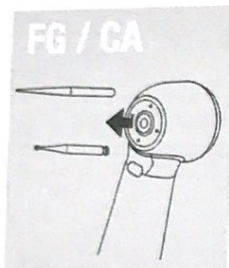

WARNING

If those marks are not completely aligned, it may lead to handpiece overheating, causing patient burn injuries.

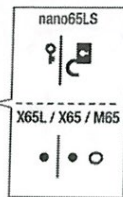
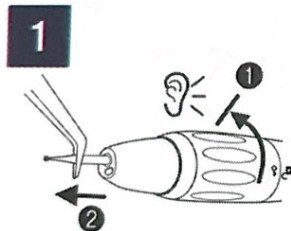
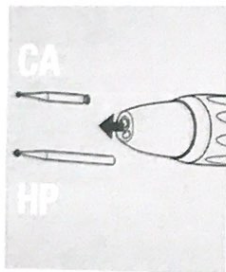

2

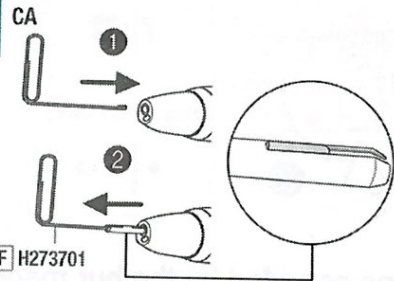

REF H273701



WARNING

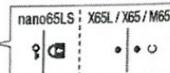
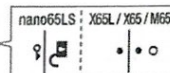
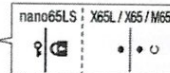

X95EX

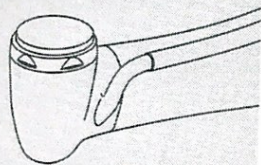

1

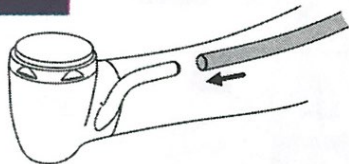

Z45L

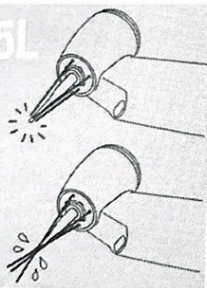

1

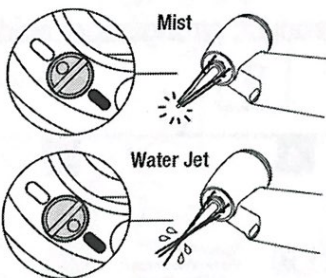
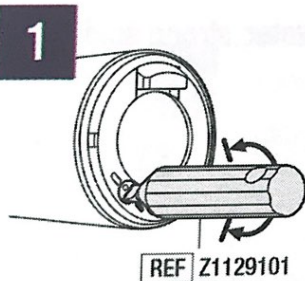

- Make sure to turn the switching valve until it stops.
- Before initiating treatment, assure the water is spraying correctly.
- If water is not being supplied correctly, recheck the switching valve.



To ensure cleaning and sterilization efficacy, use only the following procedures for reprocessing.

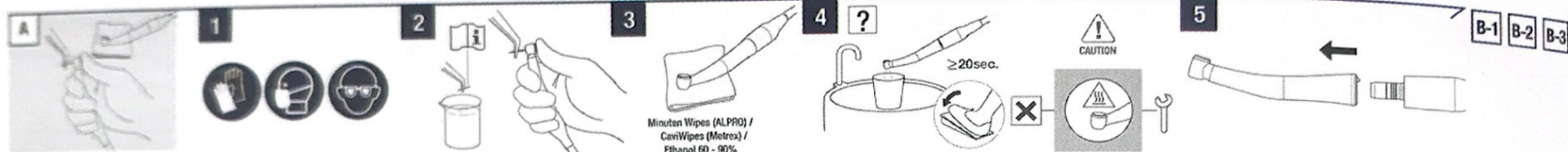

Do not use the following fluids to wipe, immerse or clean the product; strong/super acid water, strong acid/alkaline chemicals, chlorine containing solutions, solvents such as benzine or thinner.

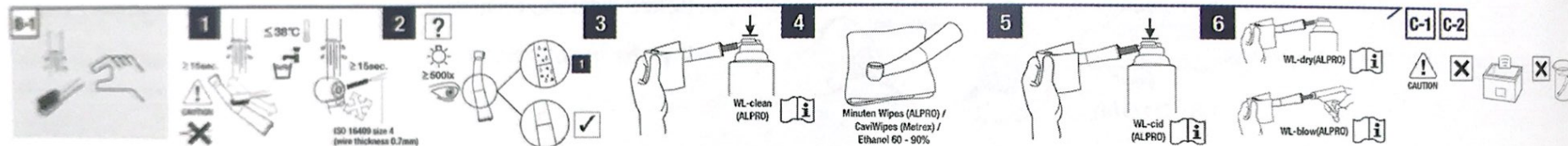

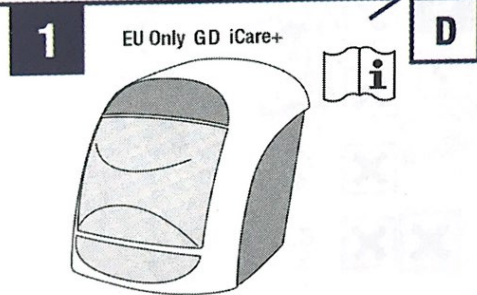
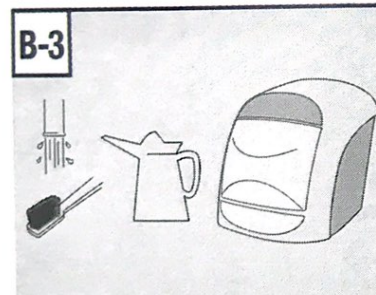
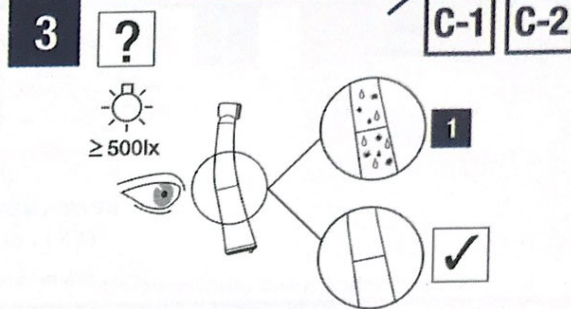
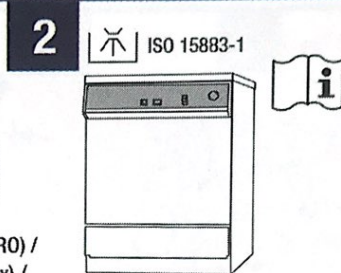
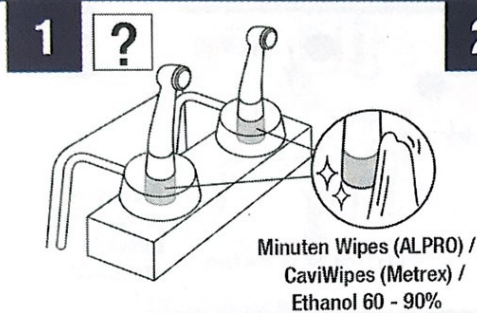
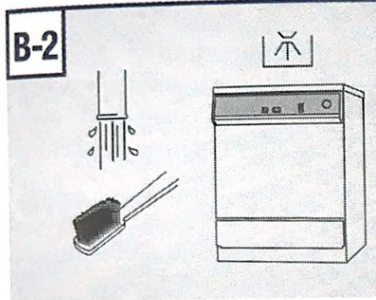

CAUTION

Remove the handpiece from the washer-disinfector immediately after the cleaning, disinfecting, and drying cycle is complete (within 1 hour), otherwise it may cause corrosion.

C-1

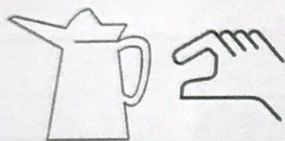

1

REF Z020010



GD PANA SPRAY Plus

REF Z182100

FG Only for FG Bur type

2



3

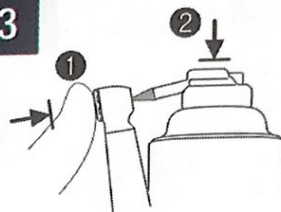

FG Only for FG Bur type



CAUTION

After washing with washer-disinfector, prior to lubrication, dry the product until all internal moisture is completely removed. Remaining moisture inside the product could reduce the effect of lubrication and could cause corrosion inside of the product.

4

REF Z019090

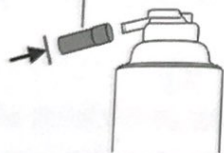

GD PANA SPRAY Plus

5

REF Y900084

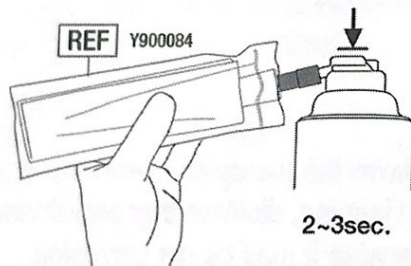

2~3sec.

6

?

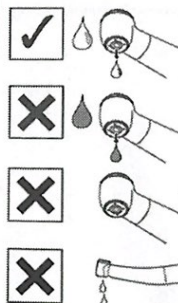

5

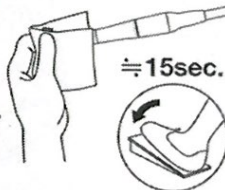

≒15sec.

D

CAUTION

X

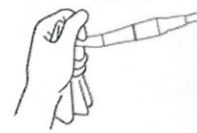

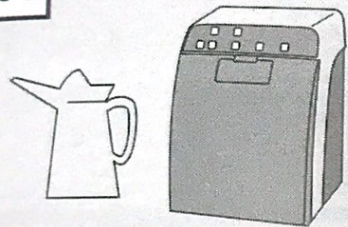
C-2**1**

GD iCare

**2**

GD iCare+ / iCare / Care3 Plus

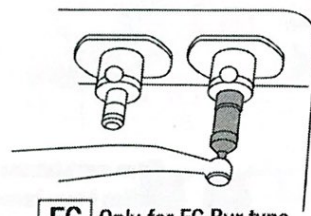
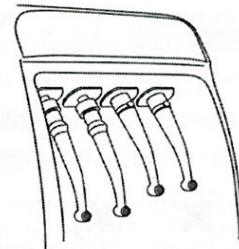
**D****FG** Only for FG Bur type**WARNING**

Immediately after a treatment (within 1 hour), perform maintenance and then store the handpiece. Failure to properly maintain the handpiece may cause infection, product failure, overheating leading to burn injuries.

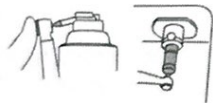
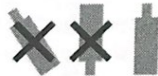
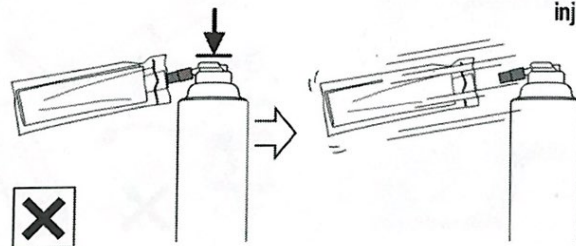
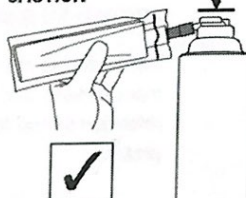
**CAUTION****FG** Only for FG Bur type**CAUTION****CAUTION**

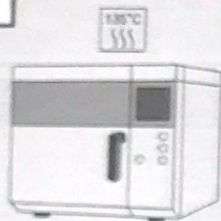
D**1**

CAUTION



ISO 11607-1



CAUTION



EN13060 / ISO17665-1



Plasma



EO



CAUTION



>135°C



CAUTION



135°C

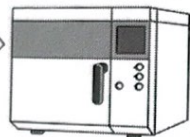

	Class N	Class B
	132°C	134°C
	≥15min	3-18min
	≥30min	≥30min

2

CAUTION

Clean and lubricate the handpiece prior to sterilization. If blood remains on the internal surface it may become clotted and cause product failure.

Immediately after sterilization is complete (within 1 hour), remove the handpiece from the sterilizer. Failure to do so may cause corrosion.

Do not heat or cool the product too quickly. Rapid change in temperature could cause damage to the product.

Sterilization is not guaranteed after the sterilization retention period specified by the manufacturer and seller of the sterilization pouch has elapsed. If the sterilization retention period has elapsed, perform sterilization again with a new sterilization pouch.

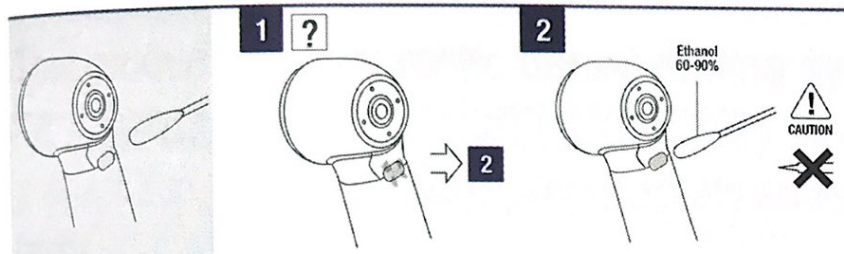

WARNING

If blood infiltrates inside a handpiece, an automatic handpiece cleaning and lubrication system may not totally clean the internal handpiece components and may lead to blood coagulation inside the handpiece. Coagulated blood may cause handpiece failure and overheating, causing burn injuries.

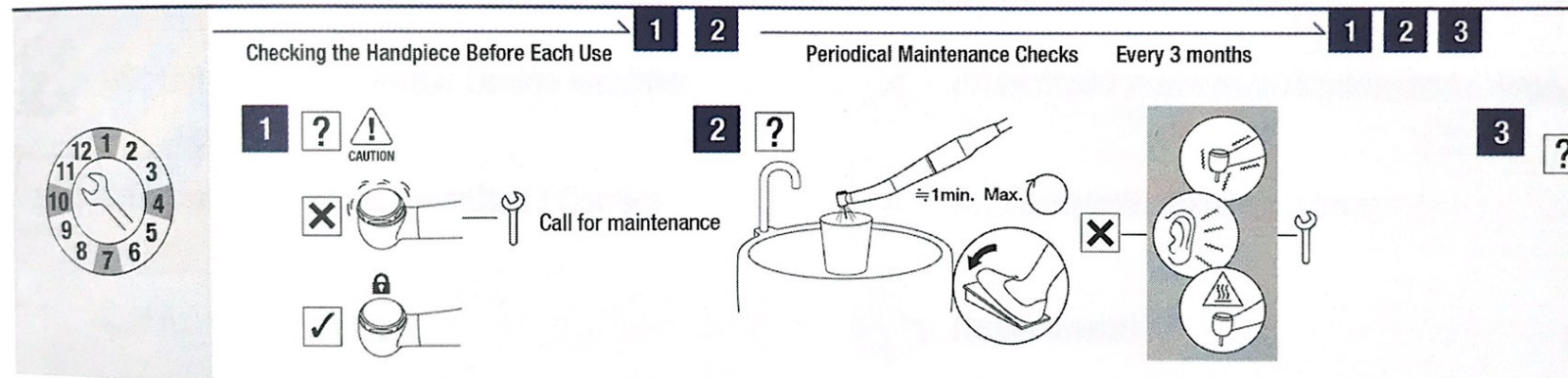

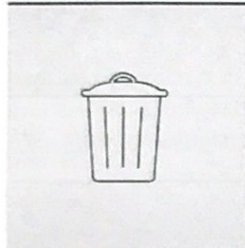

1

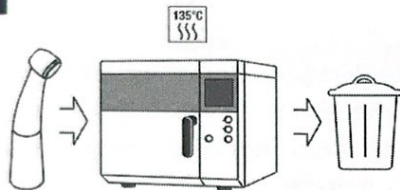

CAUTION

Be sure to sterilize before disposing. Ask specialist firms who are licensed to dispose of specially controlled medical wastes, to dispose the product for you.

Indications for use:

This product is pneumatic dental drilling system handpiece intended for removing carious material, reducing hard tooth structure, cavity preparation, finishing tooth preparations and restorations and polishing teeth.



GS1 DataMatrix for Unique Device Identifier.



Prohibited / Process NOT permitted / Wrong



Do the step / Process permitted / Correct



If.....(Hypothetical situation)



Call for maintenance



Recommend



Do not use any object with a sharp edge.



Move in the direction indicated.



Blowing off with compressed air



Drive air pressure



Water Pressure



Caution, hot surface



Drinkable tap water



Move fully to the stop, in the direction indicated.



Specifications



Chip air pressure



Exhaust air pressure



State of being fixed.



The instrument can be used with a washer-disinfector for thermal disinfection.



Medical Device



WARNING

WARNING: Hazard that could result in serious injury or damage to the device if the safety instructions are not correctly followed.



CAUTION

CAUTION: Hazard that could result in light or moderate injury or damage to the device if the safety instructions are not correctly followed.



WARNING



CAUTION



Depressing the Push Button while the handpiece is in rotation may lead to overheating, causing burn injuries or product failure. Avoid the push button to contact with any oral tissue.

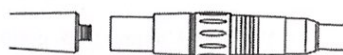
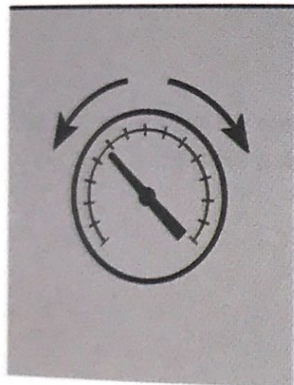

NSK / KaVo
Sirona / Bien-Air
W&H / M4

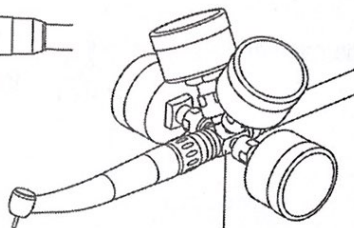

REF Z109400

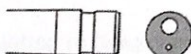

B2

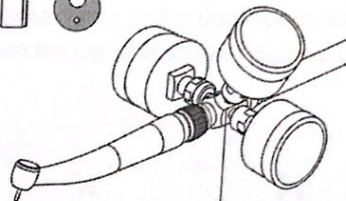

REF Z109200



WARNING



CAUTION

Follow the specifications described in this operation manual as to supply pressure, the bur to be used, etc.

Do not use air contaminated by dust, moisture or oil.

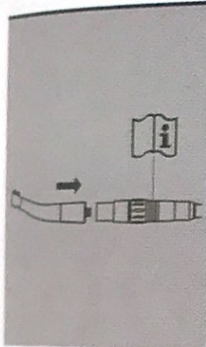

NSK / KaVo / Sirona / Bien-Air / W&H / NSK QD

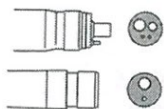

M4 / B2

1

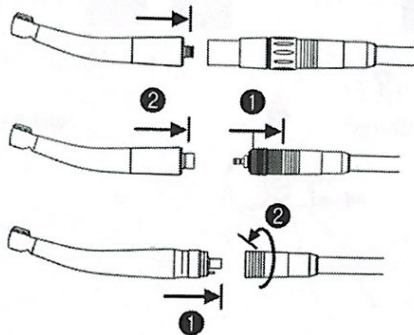

2

?

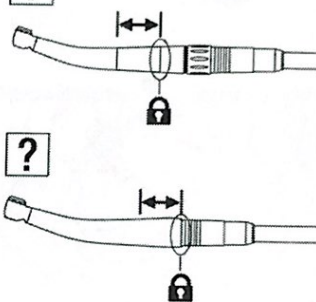

?

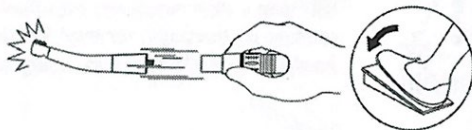
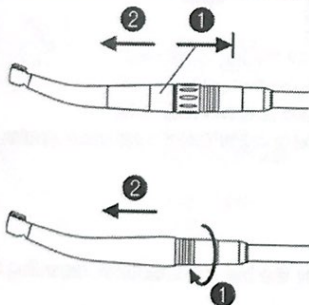
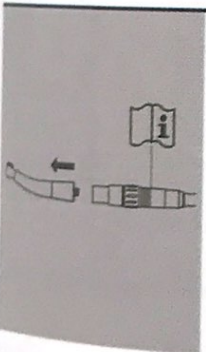

**Sudden release of the
handpiece may cause
injury.**

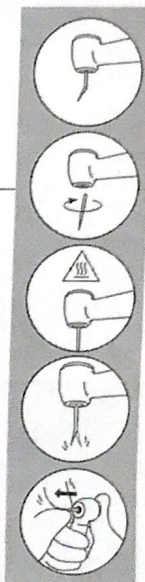
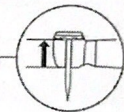
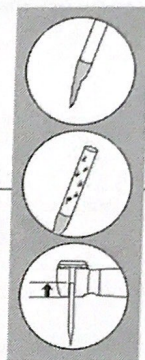
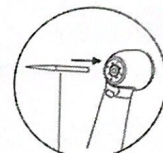
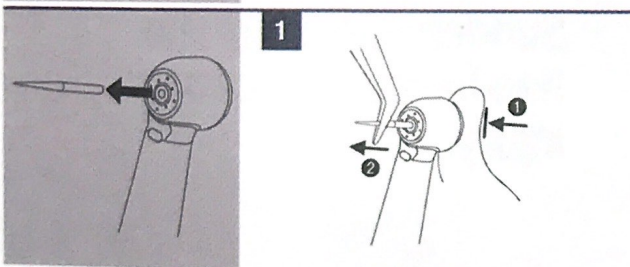
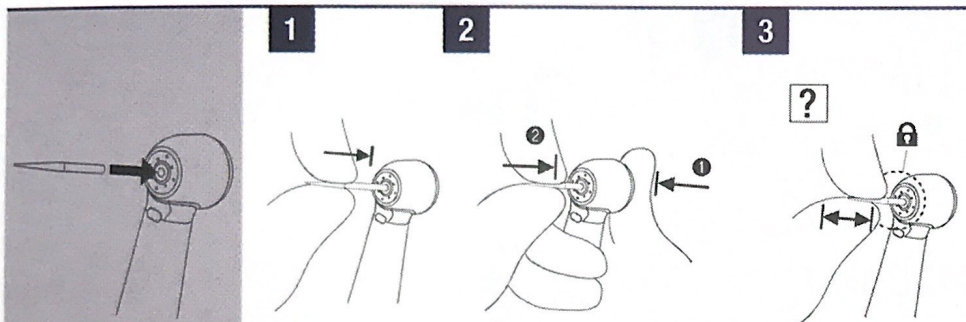

If blood or debris is stuck, wipe in and around the bur insertion hole with a cloth moistened with disinfectant solution until all residues are thoroughly removed. Residual blood or debris may enter the handpiece while changing burs, which could lead to higher risk of cross-contamination.

Always follow the instructions provided by the bur manufacturer regarding the bur usage and rotation speed, etc.



1

2

1

2

3

Checking the Handpiece Before Each Use

Periodical Maintenance Checks

Every 3 months

1

?



CAUTION

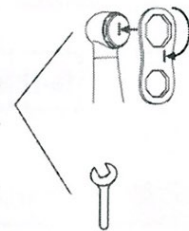

Z micro
M900 / M800
M600 / M500
M micro
S-Max pico
Pana-Max2
PAP / PAP2 / FXP

Z900 / Z800
X450

2

?

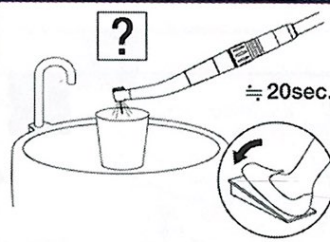

≈ 20sec.

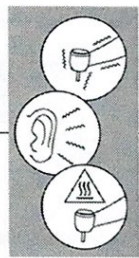

3

?

X



X



✓





To ensure cleaning and sterilization efficacy, use only the following procedures for reprocessing.

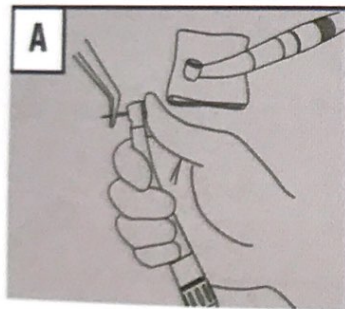

1



2

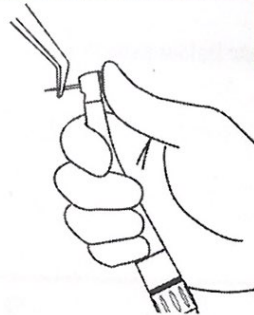

3

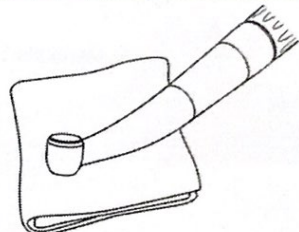

Minuten Wipes (ALPRO) /
CaviWipes (Metrex) /
Ethanol 60 - 90%

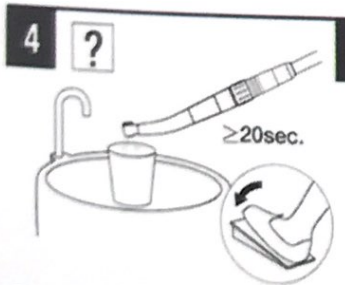

5

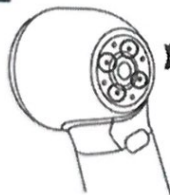

ISO 16409 size 4
(wire thickness 0.7mm)

6

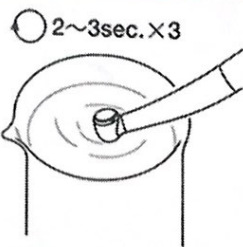

7

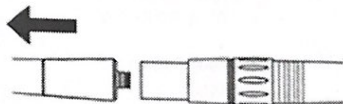

B-1

B-2

B-3

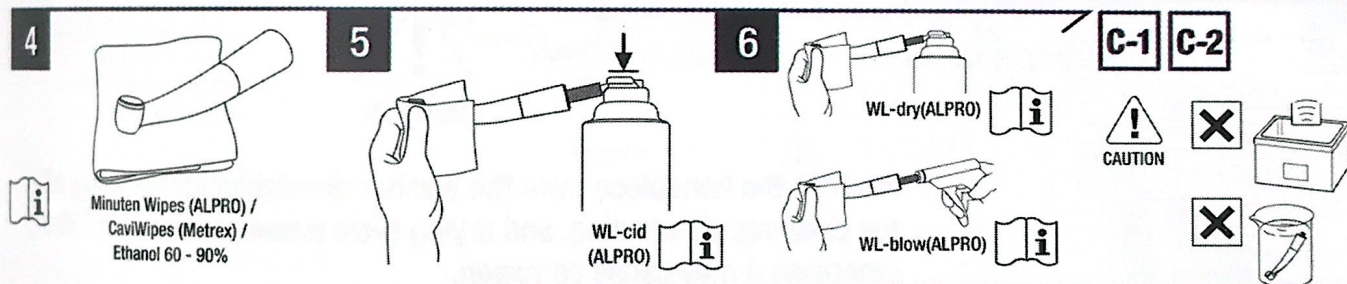
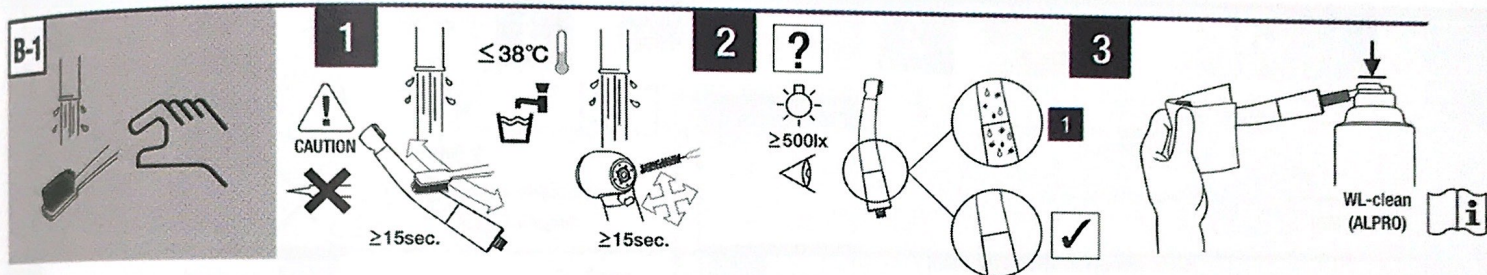

After washing with washer-disinfector, prior to lubrication, dry the product until all internal moisture is completely removed. Remaining moisture inside the product could reduce the effect of lubrication and could cause corrosion inside of the product.

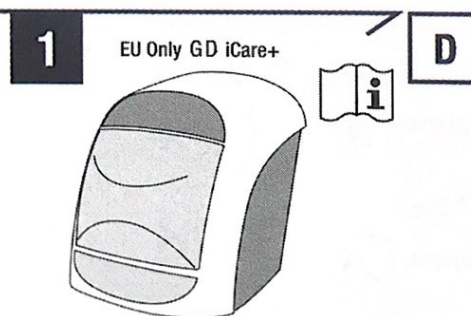
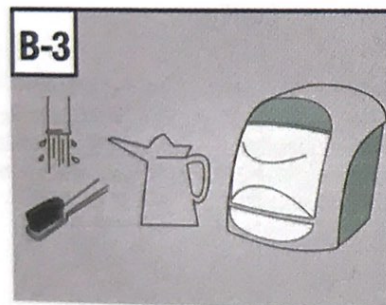
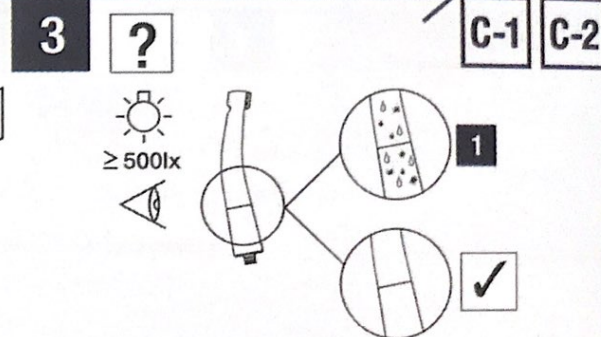
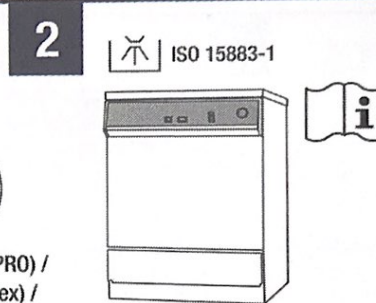
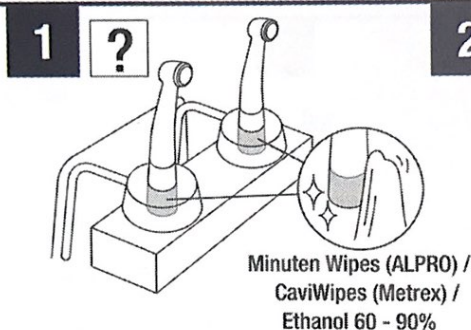
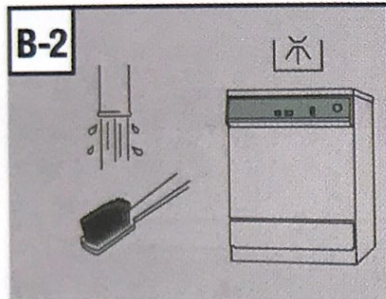

CAUTION

Remove the handpiece from the washer-disinfector immediately after the cleaning, disinfecting, and drying cycle is complete (within 1 hour), otherwise it may cause corrosion.

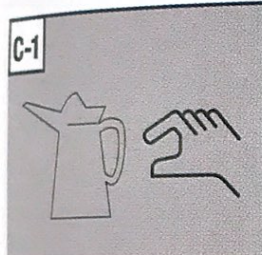

1

REF Z020010

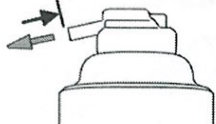

GD PANA SPRAY Plus

REF Z182100

2



3

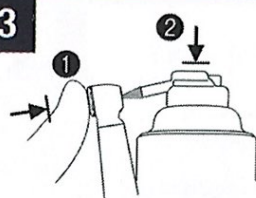

4

REF

- NSK P183090
- KaVo Z090051
- Sirona Z090052
- Bien-Air Z090053
- W & H Z090054
- NSK QD Z096090A
- M4 / B2 Z020010



GD PANA SPRAY Plus



5

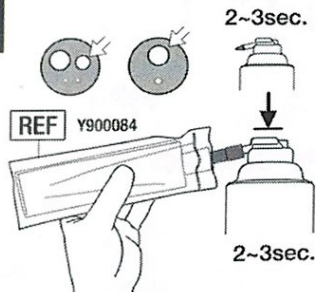

2~3sec.

2~3sec.

6

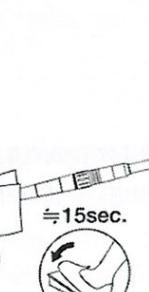
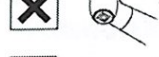

≈15sec.



It is verified that this product can be sterilized at least 250 times.

C-2

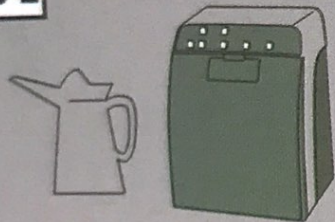

1

GD iCare

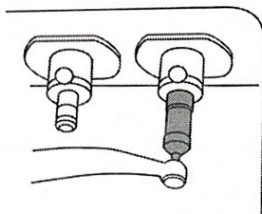

2

GD iCare+ / iCare / Care3 Plus



D

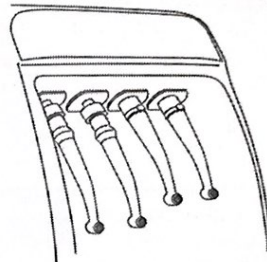

CAUTION

Immediately after sterilization is complete (within 1 hour), remove the handpiece from the sterilizer. Failure to do so may cause corrosion.



CAUTION

Store the product in a well ventilated place out of direct sunlight and within the range of temperature, humidity and pressure specified in specifications.

D

1



ISO 11607-1



EN13060 / ISO17665-1

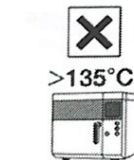

135°C

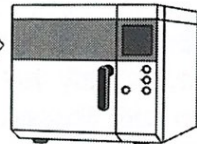

	Class N	Class B
	132°C	134°C
	≥15min	3-18min

2



CAUTION

Clean and lubricate the handpiece prior to sterilization. If blood remains on the internal surface it may become clotted and cause product failure.



CAUTION

Do not perform steam sterilization on the product with other instruments even when it is in a pouch. This is to prevent possible discoloration and damage to the product from chemical residue on other instruments.

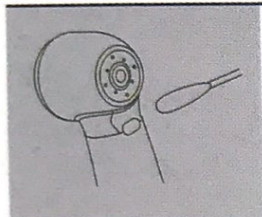

1 ?

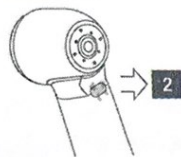

2

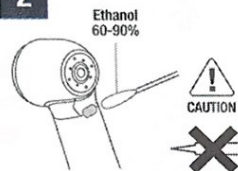

WARNING

If blood infiltrates inside a handpiece, an automatic handpiece cleaning and lubrication system may not totally clean the internal handpiece components and may lead to blood coagulation inside the handpiece. Coagulated blood may cause handpiece failure and overheating, causing burn injuries.

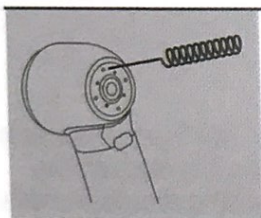

1 ?

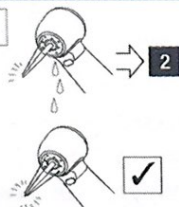

2

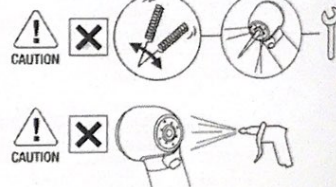
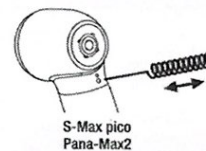
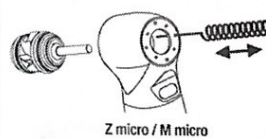
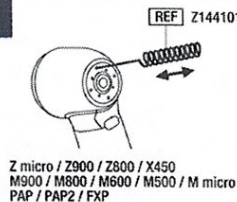

Z micro
M900 / M800
M600 / M500
M micro
S-Max pico
Pana-Max2
PAP / PAP2 / FXP

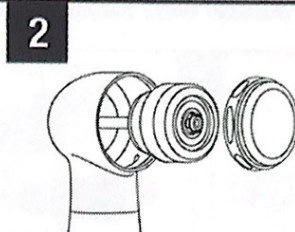
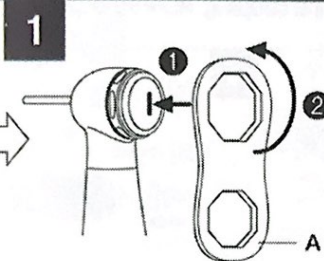

4

M900 / M800 / M600 / M500
Pana-Max2 / PAP / PAP2 / FXP

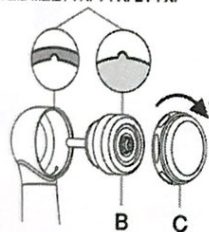

	REF		
	A	B	C
Z micro / M micro	PA2307X765	PA2307X001	PA2307X050
M800 / M500 PAP-MU PAP2-MU FXP-MU	20000535	P1280	P1001500
M900 / M600 PAP-SU PAP2-SU FXP-SU	20000535	P1281	P1027500
S-Max pico	20002803	P1140200	P1140500
Pana-Max2	P1190765	P1190	P1190050

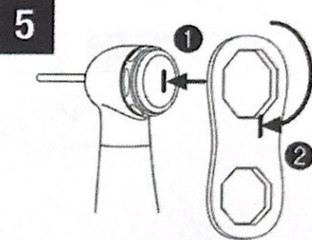
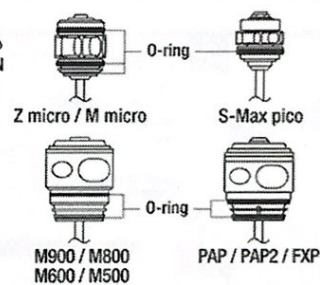

Replace the O-rings if water is present in the exhaust air line. This is an indication of possible water leakage within the coupling. **ALWAYS** change the complete set of O-rings.

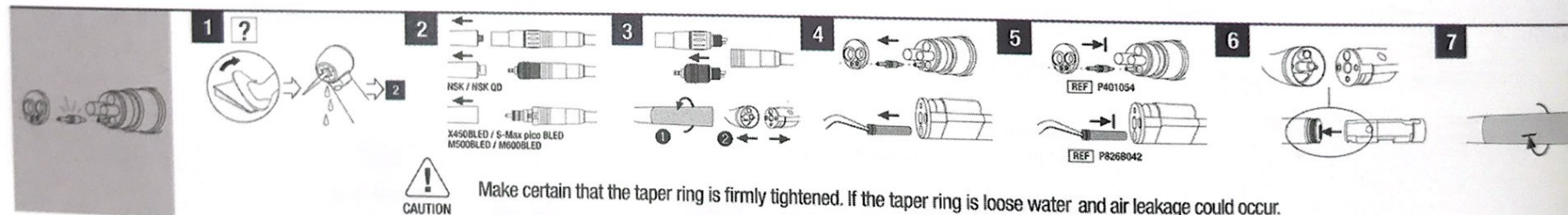
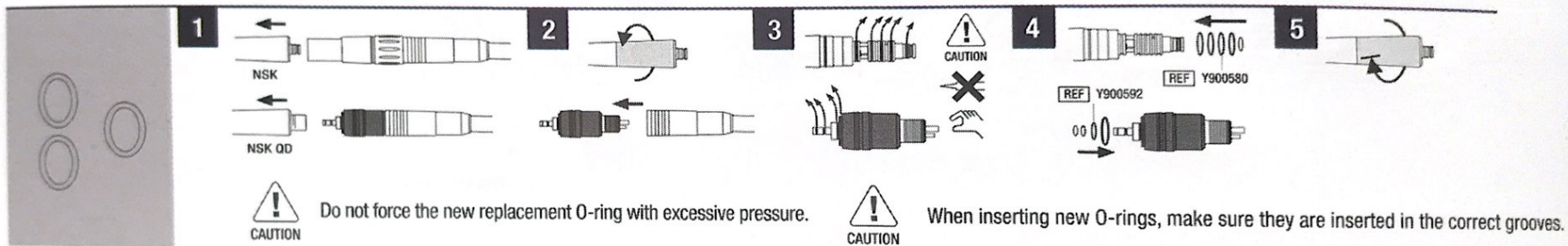

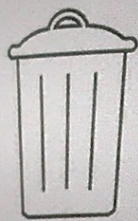

1

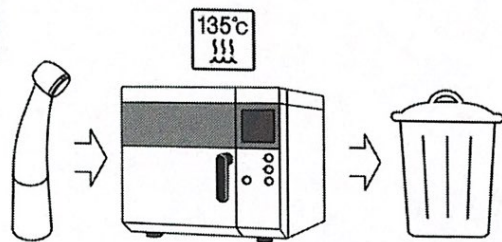

Be sure to sterilize before disposing. Ask specialist firms who are licensed to dispose of specially controlled medical wastes, to dispose the product for you.