

AIXIN MEDICAL

USER MANUAL

*AX-P3 Powerful
Sandblaster*

Description:

The AX-P3 Powerful Sandblaster is a device for polishing the surface of small objects, it has an delicate design, simple structure, and strong compatibility. It achieves automatic sand circulation according to the principle of pneumatic negative pressure siphon. The machine's advantages are: good airtightness, no overflow of sand, safe operations, artistic design and cheap price. This machine is upgraded from the AX-P2 Sandblaster, it has all the advantages of the last version. Besides, it has a built-in oil and water filtering device. The newly-designed lid makes dustless operations possible.

Specifications:

Power supply voltage	AC 220V / 110V 50HZ / 60HZ $\pm 10\%$
Pressure	6kg/cm ²
Power	<20W
Dimensions	33×40×53cm ³

Diagram:

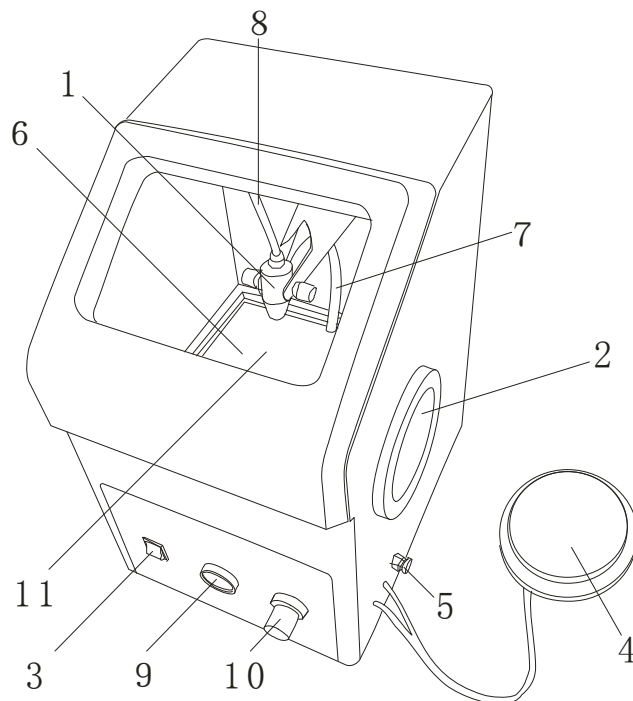

1. Nozzle
2. Ring
3. Light switch
4. Foot switch
5. Air inlet
6. Sand filter
7. Sand suction tube
8. Air tube
9. Air pressure gauge
10. Pressure-adjusting valve

11. Sand funnel

Instructions:

1. Put right amount of clean and dry emery (60 meshes) into the sand funnel from the observation window.
2. After the Sandblaster is in a stable state, connect it to the air source (pressure: 6-8kg/cm², amount of air supply $\geq 100\text{L}/\text{min}$)
3. Connect the air outlet pipe on the back of the machine to a suction or into a bucket of water in order to achieve dustless operations.
4. Connect it to a power supply, turn on the light.
5. Put the casting into the working chamber from the observation window, hold it by its side. The distance between the nozzle and the casting should not be farther than 10mm.
6. Step on the foot switch, clean the surface of the work-piece with the sand spout out from the nozzle.
7. After cleaning the surface, release the foot switch and sand stops spouting out. Open the observation window, take out the work-piece. Turn off the power after using.

Cautions:

1. The nozzles are consumable accessories, they need to be replace in tie after being worn out.
2. To replace the nozzles, unscrew the nuts on the nozzle, replace them, and assemble the new nozzle in order.
3. The emery must meet the specification of 60 meshes.
4. Users should get rid of the foreign substances in time in order to avoid it from jamming the pipes.
5. If the sand pipe is jammed, block the spout to allow the air to flow backwards and clean the pipe.
6. The sand outlet pipe must be inserted to the bottom of the sand funnel to assure the smooth flow of air in the sandblasting process.
7. Get rid of the sand in the filtering bag regularly.
8. Release water in the filtering decompression valve, clean the filter regularly.
9. While changing the observation window, make sure the gasket is installed properly, and tighten the pressure board.
10. Before using, paste thin plastic paper to the observation window (plastic wrap can be used) in order to avoid the glass of becoming dark and unclear. Change the plastic wrap regularly.

Accessories:

Manual	1
Power cord	1
Nozzle	1
Fuse tube (1A)	2
Air pipe($\Phi 8$)	1
Emery	2kg
Dust tube	1