

# **AIXIN MEDICAL**

# **USER MANUAL**

*AX-B3 Twin-pen  
Sandblaster*

## Description:

The AX-B3 Twin-pen Sandblaster is used to polish the surface of porcelain crowns, it is a necessary dental equipment. It has a large window, and the twin-pen can be used to polish materials of different hardness. The transparent bottles enable users to observe the state of the sand during the sandblasting process. The advantages are: strong sandblasting power, smooth and accurate operations, and it is easy to repair. This sandblaster is a necessary tool for polishing surface of porcelain crowns in dentistry.

## Specifications:

|               |                                       |
|---------------|---------------------------------------|
| Power voltage | AC 220V / 110V 50HZ / 60HZ $\pm 10\%$ |
| Pressure      | 4kg/cm <sup>2</sup>                   |
| Power         | <8W                                   |
| Dimensions    | 40×43×28cm                            |

## Diagram:

1. Sand bottle
2. Sand bottle
3. Pressure gauge
4. Pressure-adjusting valve
5. Directional valve
6. Ring
7. Foot switch

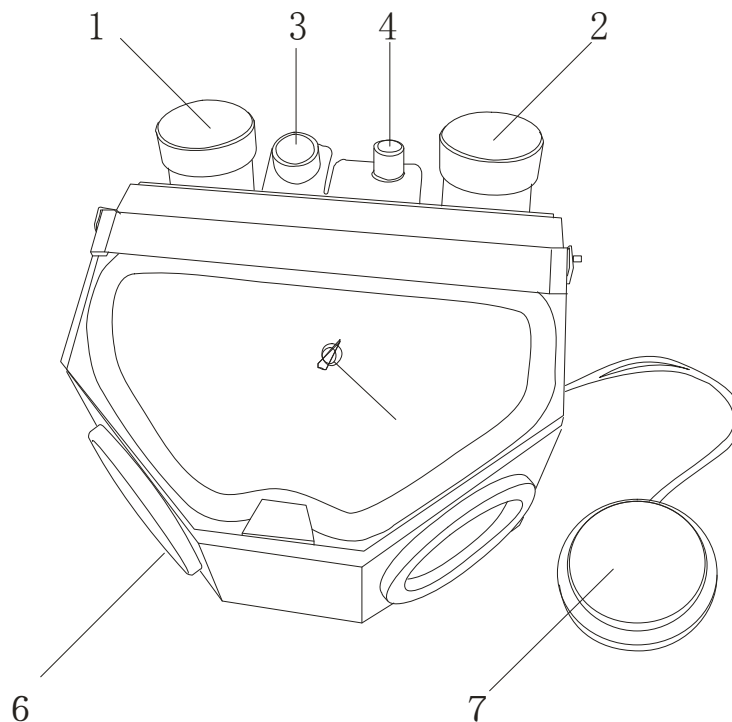

## Instructions:

1. Unpack the package, check if all the accessories are inside. Read this manual carefully before using.
2. After assembling the sandblaster, plug in the air supply pipe (pressure = 4-5 kg/cm, amount of air supplied  $\geq 80$  L/min).
3. Put quartz sand (120 meshes) into the machine.
4. Turn on the power and the light.
5. Put the casting into the working chamber from the observation window, hold the casting by its side, the distance between the casting and the nozzle should not be farther than 10 mm.
6. A hand valve is used to control the directions. One bottle contains quartz sand, and the other contains alumina.
7. To activate the sandblaster, step on the foot switch and sand will spout out from the nozzle.
8. After finish cleaning the surface of the casting, lift your foot from the foot switch, and sand will stop spouting. Open the observation window and take out the polished casting, turn off the power after using.

## Cautions:

1. While changing sand, please clean the top of the bottle and the thread of the lid carefully with a brush, make sure the lid is tightly closed.
2. Sand used in the bottle must be 120 meshes.
3. The nozzles are consumable accessories, please replace them after they are worn out.
4. When using the sandblaster, avoid using the foot switch while operating the directional valve to prevent sand from entering the directional valve.
5. When the air tube is jammed, please remove the air tube which connects to the bottle, clean the tube with air.
6. There is a build-in pressure limit valve in the sandblaster, when the pressure gauge shows 4-5, the air releases automatically in order to protect the machine and the user.

## Accessories:

|                       |   |
|-----------------------|---|
| Manual                | 1 |
| Power cord            | 1 |
| Nozzle                | 1 |
| Fuse tube (0.5A)      | 2 |
| Light (8W)            | 1 |
| Air pipe ( $\Phi 8$ ) | 1 |
| Dust pipe             | 1 |